

THE CRUISE PROGRAM

Cruise Program with Public Rates and Departure Dates (July 2009 - April 2010)

Fortnightly Saturday departures from Saigon bound to Siem Reap (upstream and downstream). Rates include accommodation, full board, all excursions, entrance fee and transportation.

8 Days/7 nights

"The lost civilization" Saigon Port (SGN) - Siem Reap (REP) and vice versa

The classic among the Mekong River Cruises - 8 day cruise "Lost civilization" for the cruise aficionados combines places rarely visited with opulent world heritage sites on board the luxury boutique cruiser "Jayavarman" - the unforgettable cruise experience.

Public rate US\$ per Cabin	Superior	Deluxe	Suite	Cruise Schedule	Jul (LS)	Aug (LS)	Sep (HS)	Oct (HS)	Nov (HS)	Dec (HS)	Jan (HS)	Feb (HS)	Mar (HS)	Apr (LS)
Low Season (LS)	2675	2958	3315	SGN - REP	on req.	1/15/29	12/26	10/24	7/21	5/19	2/16/30	13/27	13/27	on req.
High Season (HS)	4115	4550	5100	REP - SGN	on req.	8/22	5/19	3/17/31	14/28	12/26	9/23	6/20	6/20	on req.

5 days/4 nights

"Serenity Cruise" Phnom Penh (PNH) - Siem Reap (REP) v.v.

Best of rural Cambodia, off the beaten track

Public rate US\$ per Cabin	Superior	Deluxe	Suite	Cruise Schedule	Jul (LS)	Aug (LS)	Sep (HS)	Oct (HS)	Nov (HS)	Dec (HS)	Jan (HS)	Feb (HS)	Mar (HS)	Apr (LS)
Low Season (LS)	1542	1696	1900	PNH - REP	on req.	4/18	15/29	13/27	10/24	8/22	5/19	2/16	2/16/30	on req.
High Season (HS)	2056	2262	2533	REP - PNH	on req.	8/22	5/19	3/17/31	14/28	12/26	9/23	6/20	6/20	on req.

4 days/3 nights

"Pearl of the Orient" Saigon Port (SGN) - Phnom Penh (PNH) v.v.

The 4 day cruise "Pearl of the Orient" for the cruise aficionados with less time at their hands connecting the Pearl of the Orient with Paris of the East giving you some awe inspiring moments underway, deep in the Mekong Delta.

Public rate US\$ per Cabin	Superior	Deluxe	Suite	Cruise Schedule	Jul (LS)	Aug (LS)	Sep (LS)	Oct (HS)	Nov (HS)	Dec (HS)	Jan (HS)	Feb (HS)	Mar (HS)	Apr (LS)
Low Season (LS)	1268	1395	1534	SGN - PNH	on req.	1/15/29	12/26	10/24	7/21	5/19	2/16/30	13/27	13/27	on req.
High Season (HS)	1690	1859	2045	PNH - SGN	on req.	12/26	9/23	7/21	4/18	2/16/30	13/27	10/24	10/24	on req.

3 Days/2 nights

"Deep in the Delta" Saigon (SGN) - Chau Doc (CD) v.v.

For the discerned traveler this voyage provides a glimpse of the lower Mekong and its tributaries on the most comfortable luxurious means of transportation.

Public rate US\$ per Cabin	Superior	Deluxe	Suite	Cruise Schedule	Jul (LS)	Aug (LS)	Sep (LS)	Oct (HS)	Nov (HS)	Dec (HS)	Jan (HS)	Feb (HS)	Mar (HS)	Apr (LS)
Low Season (LS)	743	817	915	SGN - CD	on req.	1/15/29	12/26	10/24	7/21	5/19	2/16/30	13/27	13/27	on req.
High Season (HS)	990	1089	1220	CD - SGN	on req.	13/27	10/24	8/22	5/19	3/17/31	14/28	11/25	11/25	on req.



HERITAGE
— LINE —

THE DECKS

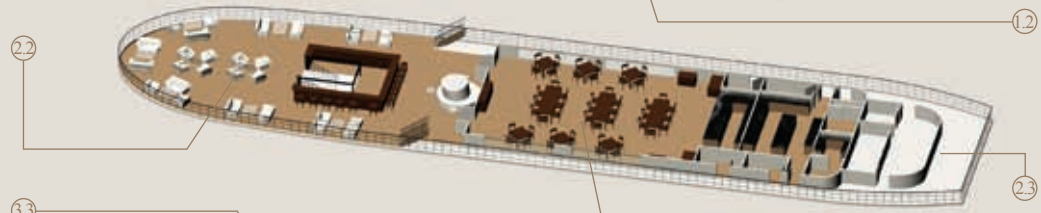
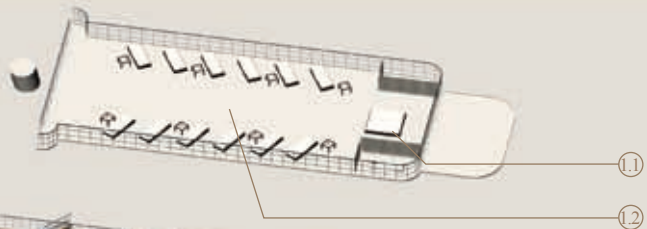

HERITAGE
— LINE —

THE CABINS

Accommodation – A Sanctuary of Style and Space

Superior, Deluxe stateroom and 2 themed suites matching your needs.

Carefully designed staterooms and suites with floor to ceiling windows and sliding doors onto a private balcony and many thoughtful touches offering privacy and uncompromised luxury.

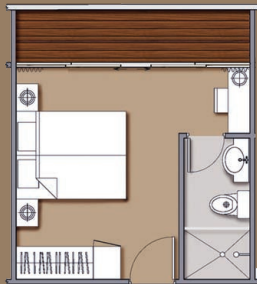
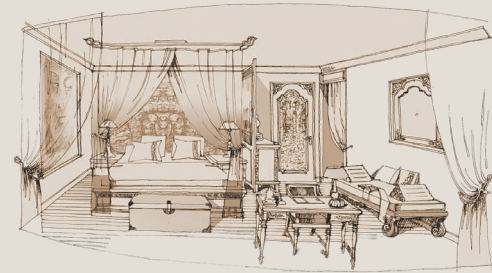

SUPERIOR CABIN

14 superior cabins - main deck, 21m² incl. private balcony
All twin bed (85 x 200cm) convertible into a king size bed

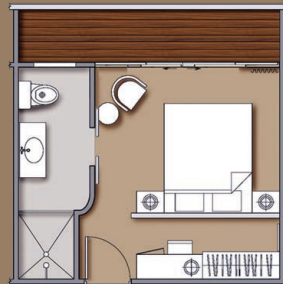

DELUXE CABIN

11 deluxe staterooms - upper deck, 24m² incl. balcony
2 rooms with twin bed, 8 rooms with king size bed (180 x 200cm), 1 room with adjoining capabilities.
Third berth availability.

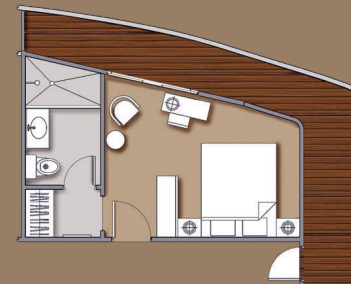

ROYAL JUNIOR SUITE

2 themed Royal junior suites - upper deck, 26m² incl. corner balcony
Expansively elegant stateroom designed to perfection. Themed after "Jayavarman VII", King of the Khmer and Vietnams last Emperor – "Bao Dai"
King size bed (180x200cm) and a range of additional amenities/presents

AMENITIES AT A GLANCE:

- Well appointed bathroom with double vanity and glass shower cabin
- All furniture and floor in tropical hardwood
- Personal mini bar and coffee/tea making facilities
- Safe deposit box and In-house phone
- In-suite temperature controls
- Bath robe, Slippers, hair dryer and bath robe
- Bathroom amenities
- Life vest, fire extinguisher, smoke detector
- Evening turndown services and daily gifts
- 24 hr room service
- Daily fruit basket and a bottle of Prosecco on arrival (suite only)
- I-pod station, pre-recorded (deluxe and suite only)



HERITAGE
— LINE —

THE SERVICE + FACILITIES

Public Guest Areas – Relaxed Elegance, Colonial Style

Comfortable and generous guest areas on 800 m², designed with an uncompromising attention to detail, influenced by a distinctive Indochine design.

- Lobby lounge, observatory and reception with boutique shop.
- Dining room, funnel bar & lounge terrace, upper sun deck and wheelhouse platform.
- F&B outlets: dining room, lobby lounge, breakfast deck, funnel bar & lounge terrace.
- Library with Internet workstation
- Massage and beauty salon area indoor/outdoor

Activities/Entertainment:

- Fascinating shore programs discovering a more experiential Indochina (humanitarian, educational, cycling, sightseeing, rickshaw, ox cart, boating, walking)
- Theme night with traditional Khmer music and Apsara dance performance
- Movie nights and lectures (demographic, Khmer art, geographic, humanitarian)
- Fundraising roulette
- Board games (Chess, Backgammon, Dart etc.)
- Khmer-Vietnamese cooking workshop
- Tasting workshop - tea, coffee, and juices
- Wheelhouse bicycle
- Early bird Thai Chi lessons
- In-outdoor Massage and beauty salon

Food & Beverage outlets:

- Breakfast deck - Continental breakfast buffet
- High tea at the observatory
- Funnel bar & lounge with sundowner drinks and snacks a la carte
- Dining room with western cuisine and Khmer and Vietnamese specialties.
- Seafood barbeque and farewell dinner at the sun deck seafood-barbeque and farewell dinner
- 24 hours in suite dining service

Exceptional on board Services:

- Daily Newspaper in English, French and German
- 24 hours room service
- I-Pod rental
- Turndown service and daily presents
- Laundry service
- 24 -hour security
- IDD and Internet available at the reception
- Doctor on call
- Library with books, arts literature, music and games
- Boutique shop with magazines, literature, toiletries, travel items, clothes and handicrafts

CAPACITY (PUBLIC FACILITIES)

Venue	Activity	Guest capacity	Aircon
1. Lounge/Observatory “Henry Mouhot”	Briefings and lectures	56	x
	Comfy movie nights	34	x
	High Tea or breakfast	34	x
2. Funnel Lounge & Bar “Club 1930”	Pre-dinner cocktail events	70	
	Briefings and lectures	56	
	Movie nights, show and entertainment	56	
	Breakfast or lunch	32	
3. Sun deck	Captains dinner and farewell dinner	56	
	Continental breakfast served on lap trays on the sun chair	20	
	Sun bathing	20	
4. Restaurant “Indochine”	Breakfast, lunch and dinner (buffet or set menu)	56	x
5. Massage & Beauty “Apsara”	Massage indoor	3	x
	Massage outdoor	1	
	Beauty	1	x

FACTS & FIGURES

Launch	: June 2009
Vessels Registry	: Vietnam
Type of Vessel	: River and sea going vessel
Length	: 58 m
Beam	: 11 m
Draft	: 1.6 m
Decks	: 5 — lower, main, upper, terrace and sun deck
Gross tonnage	: 700 tons
Engine	: 2 x 600 HP
Electricity	: 220 volts
Cruising speed	: 10 nautical knots
Water	: Reverse osmosis and UV water treatment plant
Crew	: 38 (Cambodian hotel staff, Vietnamese crew) and international cruise manager



HERITAGE
— LINE —